

Caper® XR

High-performance multipurpose chair

Assembly instructions



A Herman Miller® Original

For proper assembly, it's important to read through the instructions for all 4 steps and follow them carefully. The assembly process is quick, but we're not timing you. Speed is less important than getting it right.

Notice:

Some of the parts have been wrapped to protect them during shipping. Remove the plastic wrap before assembling the chair.

Questions?

Email us at costcosupport@hermanmiller.com or call 1-800-525-8164.

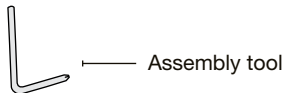
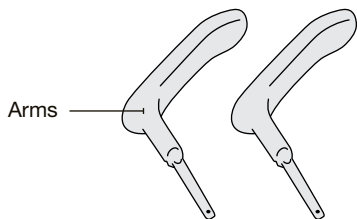
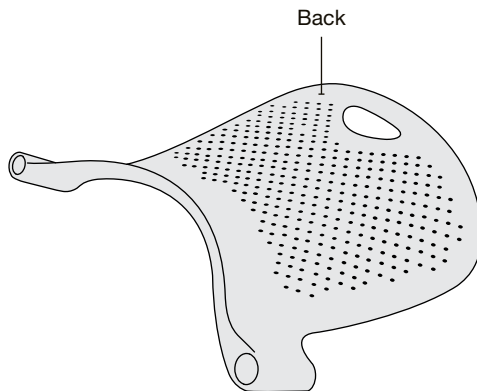
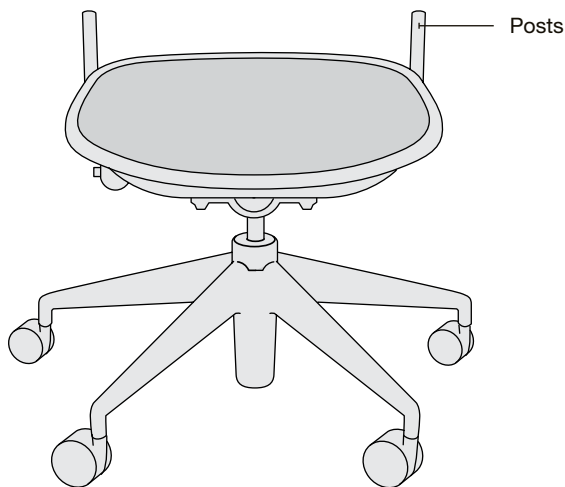

Step 1

Start the setscrews.

You need to get the setscrews started by hand before connecting the rest of the parts.

Pointy ends go into the posts, righty-tighty.

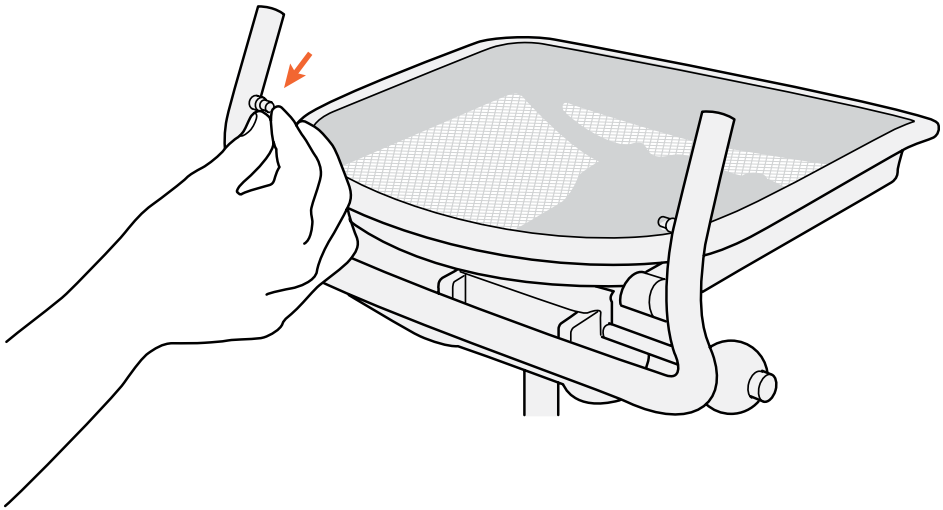

Step 2

Attach the back.

Place the back onto the posts as shown.
Back should be firmly in place.

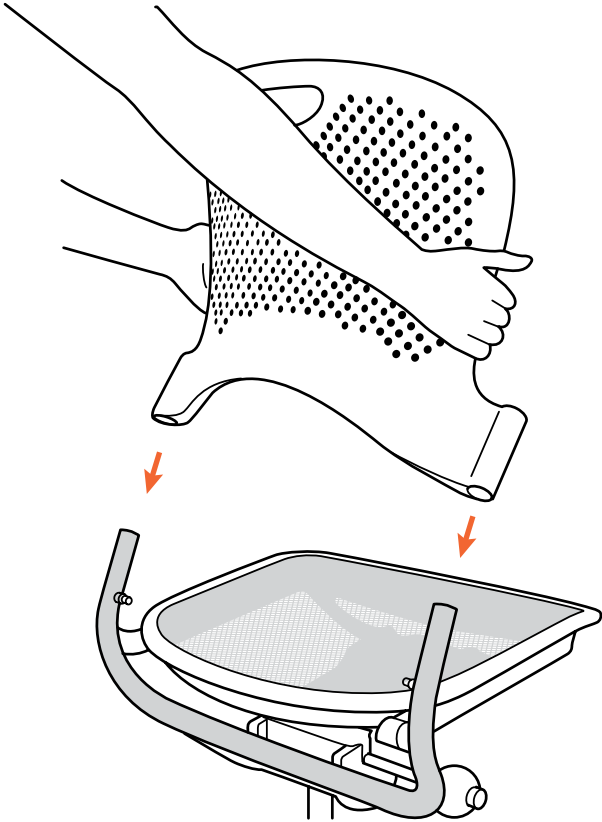

Step 3

Attach the arms.

Lower the arms into the posts as shown. To tell right from left (there is a difference), look for the dimples on the arm stems. These dimples should go on the inside (seat-side) of the chair and line up with the setscrews.

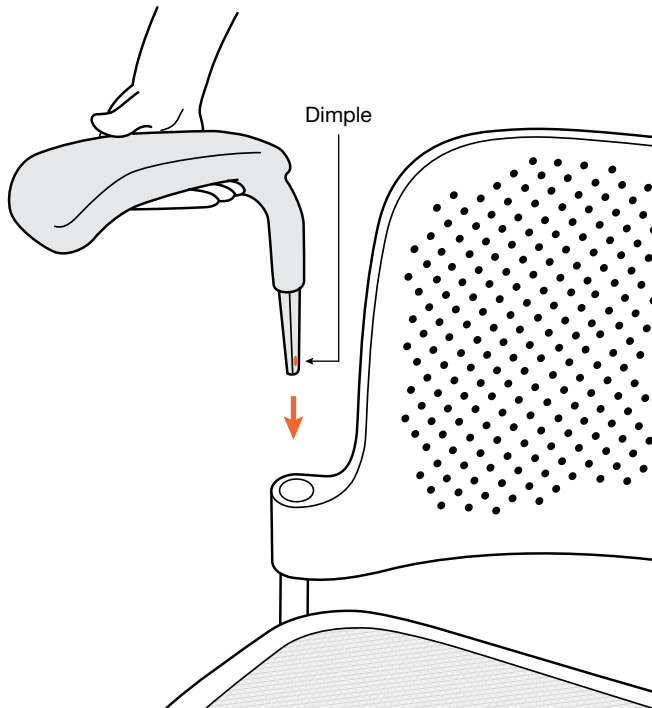

Step 4

Tighten the setscrews.

Use the assembly tool from your hardware pack to finish tightening the setscrews you started in Step 1. You can use either end of the tool, but since it's a tight squeeze back there, it works best to use the long end first as shown in **Figure A**.

Turning clockwise, tighten the setscrews until you can't tighten them any further with the long end of the tool. Then turn the tool over and do a few final turns with the short end as shown in **Figure B**.

Keep tightening until the arms are firmly secured to the chair – that means they will not wiggle.

Congratulations! Your new Caper XR chair is ready to spice up any workspace. (We installed the personality at the factory.)

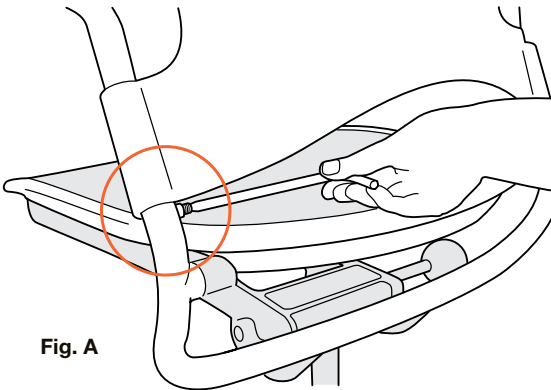

Fig. A

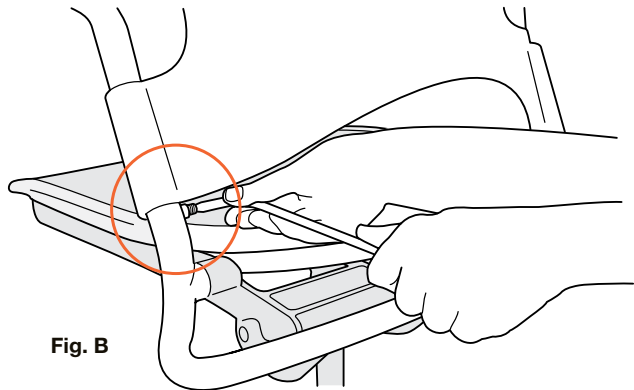

Fig. B